

HONESTYTM

PARKING



Manufacturing by :
HONESTY AUTOMATION PVT. LTD.
A Unit of Honesty Group

STACK PARKING | PIT PARKING | PUZZLE PARKING | ROTARY PARKING | TOWER PARKING

PRODUCT INDEX

ABOUT HONESTY

We are a customer focused car parking system solution manufacturer.

Honesty Automation Pvt. Ltd., a unit of Honesty Group is established in 2009 with strong vision to deliver most reliable & economical solutions in Parking industry. Today HAPL is one of the fastest growing company with maximum satisfied customer base in India. The company has a trained workforce of 50+ employees in about 30,000 Sq. Ft. area with well-equipped workshop capable of delivering utmost quality product and continuous service backup.

We at **HAPL** believe to deliver high quality products at competitive price supported by best service team. We have developed in-house manufacturing facilities, focused manufacturing processes with in-depth technology, sales network associates across in India. Customer care team is always ready in short time at your doorstep for solving our customer queries. Our skilled team has already achieved in best performance in satisfying diverse needs of customer.



Factory image 1



Factory image 2

❖ STACK PARKING SYSTEM (HYDRAULIC & MECHANICAL)

Page

- Stack Park 210 (Ground & Above)
- Stack Park 210 (Ground & 2Above)
- Cantilever Stack Park 400

❖ PIT PARKING

Page

- Pit- Stack Parking 310 (Pit, Ground & Above)
- Pit- Stack Parking 320 (Pit & Ground Independent)
- Stack Parking 340 (Pit & Ground)

❖ HYDRAULIC PUZZLE PARKING SYSTEM

Page

- 2 Level Puzzle Parking System (+2)
- 2 Level Puzzle Parking System (-1 & +Ground)
- 3 Level Puzzle Parking System (-1 & +2)
- Combination of 2 Level Puzzle Parking System
- Combination of 2 & 3 Level Puzzle Parking System

❖ MECHANICAL PUZZLE PARKING SYSTEM

Page

- Over Ground Puzzle Parking System (2 to 8 Levels)
- 1 in Pit 7 Above Puzzle Parking System (-1 & +7)
- 2 in Pit 6 Above Puzzle Parking System (-2 & +6)
- 3 in Pit 5 Above Puzzle Parking System (-3 & +5)

❖ TOWER PARKING SYSTEM

Page

- Single Side Tower Parking System
- Both Side Tower Parking System (1+1)
- Double Deep Tower Parking System (2+2).
- Triple Deep Tower Parking System (3+3)

❖ MINI-ROTARY PARKING

Page

- Mini- Rotary Parking System (16 Cars Sedan)
- Mini- Rotary Parking System (12 Cars SUV)

❖ STACK PARKING SYSTEM G+1

Stack Parking System is the economical and simple parking solution for new buildings or existing societies where parking can be doubled. This is designed to be fit on the surface and double the car space by stacking the cars one above the other. The car must be driven off before the upper platform is lowered.

The stack parking system is designed to park cars of different heights as per the height availability at customer's location. It is perfect for the residential, commercial projects and parking garages where vertical stacking of the cars is desired.

| Descriptions | Stack Parking Dependent Type | |
|------------------------------------|------------------------------|------------------------|
| | Small Size Car | SUV's |
| Platform Length (mm) | 4000to 4500 | 4800 to 5000 |
| Platform Width (mm) | 2200 | 2500 |
| Lifting Capacity per Platform (Kg) | 2500 | 3000 |
| Lifting Height | 1500 to 2000 | 1900 to 2100 |
| Lifting Operation | Hydraulic & Mechanical | Hydraulic & Mechanical |
| Motor on Power Pack | 2.2KW/3HP | 2.2KW/3HP |
| Operating Panel | Automatic and Manual | Automatic & Manual |

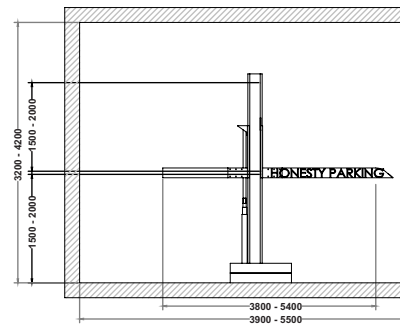

Standard Features:

- Installed in basement or open space
- Easy entry and exit.
- Dependent parking system.
- Can fit 2 cars in the system.
- Easy to maintain, low maintenance cost.
- Car height included antenna, road rails & brackets.
- Competitive pricing
- Maintenance free parking
- Limit switches to restrict the travel height by auto cutting off the motor.
- Modules customized as per site dimensions
- Powder coated, galvanized (optional) or epoxy
- Chain supported balancing and lifting mechanism
- Rust free platforms
- Emergency shutdown switch.
- Noise pollution level depends on the location & type of structure

❖ STACK PARKING SYSTEM G+2

Car parking system providing dependent parking spaces for three cars one on top of the each other. The vehicle parks directly on the floor plate form. The vehicle parked on ground must be driven out before lowering the platforms. Its is based on hydraulic systems and the high-tech mechanism has an innovative pallet that is lifted up and after that the car is loaded, Simple operated. An operation control panel can be conveniently located anywhere in the garage, basements and outdoors for operation.

| Descriptions | Stack Parking Dependent Type | |
|------------------------------------|------------------------------|------------------------|
| | Small Size Car | SUV's |
| Platform Length (mm) | 4000to 4500 | 4800 to 5000 |
| Platform Width (mm) | 2200 | 2500 |
| Lifting Capacity per Platform (Kg) | 2500 | 3000 |
| Lifting Height | 1500 to 2000 | 1900 to 2100 |
| Lifting Operation | Hydraulic & Mechanical | Hydraulic & Mechanical |
| Motor on Power Pack | 2.2KW/3HP | 2.2KW/3HP |
| Operating Panel | Automatic and Manual | Automatic & Manual |

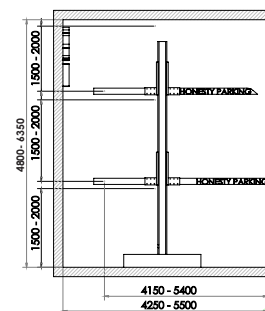
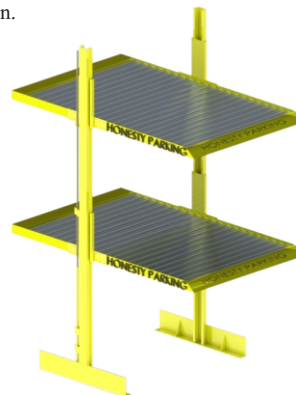

Standard Features:

- Installed in basement or open space
- Easy entry and exit.
- Dependent parking system.
- Can fit 3 cars in the system.
- Easy to maintain, low maintenance cost.
- Car height included antenna, road rails & brackets.
- Limit switches to restrict the travel height by auto cutting off the motor.
- Competitive pricing
- Maintenance free parking
- Modules customized as per site dimensions
- Powder coated, galvanized (optional) or epoxy
- Chain supported balancing and lifting mechanism
- Rust free platforms
- Emergency shutdown switch.
- Noise pollution level depends on the location & type of structure

CANTILEVER STACK PARKING SYSTEM

This system is installed to park only one car on the platform and the ground level is left clear for vehicular movements. The system has column arrangement only on one side, generally on the boundary side, leaving the entire driveway clear for passage

| Descriptions | Cantilever Stack Parking (Dependent Type) | |
|------------------------------------|---|------------------------|
| | Small Size Car | SUV's |
| Platform Length (mm) | 4000to 4500 | 4800 to 5000 |
| Platform Width (mm) | 2200 | 2500 |
| Lifting Capacity per Platform (Kg) | 2500 | 3000 |
| Lifting Height | 1500 to 2000 | 1900 to 2100 |
| Lifting Operation | Hydraulic & Mechanical | Hydraulic & Mechanical |
| Motor on Power Pack | 2.2KW/3HP | 2.2KW/3HP |
| Operating Panel | Automatic and Manual | Automatic & Manual |

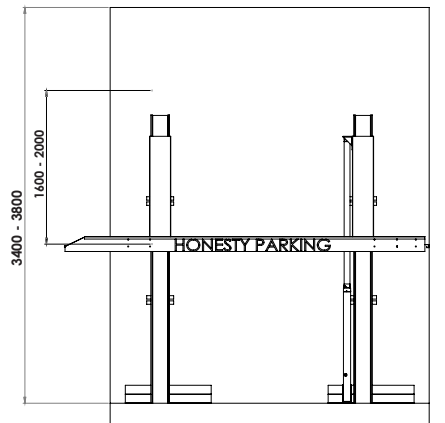

Standard Features:

- Vehicles can be driven across stacks.
- One platform per system.
- Lifting mechanism installed only on one side of the stack.
- Color scheme for the system will be provided as per the client's color theme .
- Hot dipped galvanized corrugated floor plates to reduce dead weight and increase durability .
- Compact power pack system with enclosed motors and rubber bush fittings for reduced noise levels.
- Optional photo sensor for the bottom car to prevent accidental lowering of upper stack .
- Electromagnetic locking mechanism to prevent unwanted lowering of upper stack.
- Limit switches to restrict the travel height by auto cutting off the motor.
- Remote switch box with key/push button for easy operation.
- Emergency shutdown switch

❖ PIT PARKING SYSTEM

It includes two interconnected platforms that are driven upwards and downwards together. One car is parked on the top platform & the other car is parked on the bottom platform. For entry or exit of any car, system makes the upward & downward movement to settle the platform at ground level, of which car needs to be taken out. E.g. - To take out the lower car in pit, system takes up both the platforms together and lower car reaches the ground level.

| Descriptions | Pit Parking (Independent) | |
|------------------------------------|-------------------------------|-----------------------------------|
| | Small Size Car | SUV's |
| Platform Length (mm) | 4800 to 5000 | 4500 to 5000 |
| Platform Width (mm) | 2300 to 2500 | 2300 to 2550 |
| Lifting Capacity per Platform (Kg) | 2000Kg | 2000 |
| Lifting Clearance | 1700 to 1800 | 1800 to 2000 |
| Lifting Operation | Hydraulic & Electromechanical | Hydraulically & Electromechanical |
| Motor on Power Pack | 2.2KW/5HP | 2.2KW/5HP |
| Operating Panel | Automatic / Manual | Automatic / Manual |

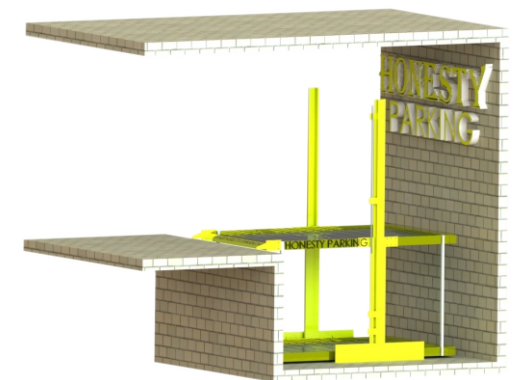

Standard Features:

- Two platforms per system.
- One platforms on ground & one in pit.
- Color scheme for the system can be provided as per the client's requirement.
- Hot dipped galvanized corrugated floor plates on platforms to reduce dead weight and increase durability.
- Hydraulic cylinders & chain supported balancing used for lifting mechanism
- Compact power pack system with enclosed motor and rubber bush fittings for reduced noise levels.
- Optional photo sensor for the middle car to prevent accidental lowering of upper stack or lifting of the lower stack.
- Electromagnetic locking mechanism to prevent unwanted lowering of upper stacks.
- Limit switches to restrict the travel height by auto cutting off the motor.
- Remote switch box with key/push button for easy operation.
- Emergency shutdown switch.

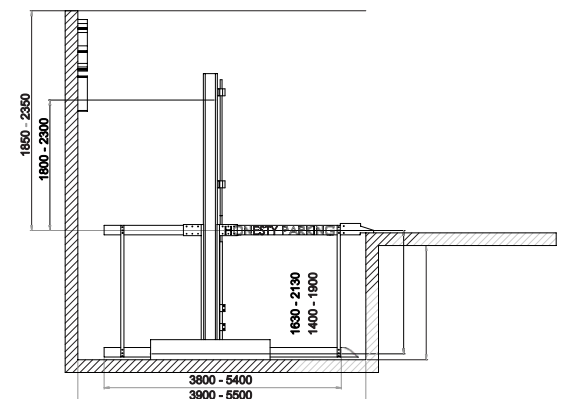

3DP uses 3 platforms, 2 of which (entry and lower level) are interconnected and upper level platform is driven upwards and downwards separately. To take out upper or lower level car, entry-level car has to be driven out and parked elsewhere.

| Descriptions | Pit Parking (Independent) | |
|------------------------------------|-------------------------------|-----------------------------------|
| | Small Size Car | SUV's |
| Platform Length (mm) | 4800 to 5000 | 4500 to 5000 |
| Platform Width (mm) | 2300 to 2500 | 2300 to 2550 |
| Lifting Capacity per Platform (Kg) | 2000Kg | 2000 |
| Lifting Clearance | 1700 to 1800 | 1800 to 2000 |
| Lifting Operation | Hydraulic & Electromechanical | Hydraulically & Electromechanical |
| Motor on Power Pack | 2.2KW/5HP | 2.2KW/5HP |
| Operating Panel | Automatic / Manual | Automatic / Manual |

Standard Features:

- Installed in basement & open space
- One platforms on ground & one in pit & one platform G+1.
- Easy entry and exit.
- Dependent parking system.
- Can fit 3 cars in the system.
- Hydraulic cylinders & chain supported balancing used for lifting mechanism
- Easy to maintain, low maintenance cost.
- Car height included antenna, rood rails & brackets.
- Modules customized as per site dimensions
- Powder coated, galvanized (optional) or epoxy.
- Available in 2 ton & 2.5 ton (optional)

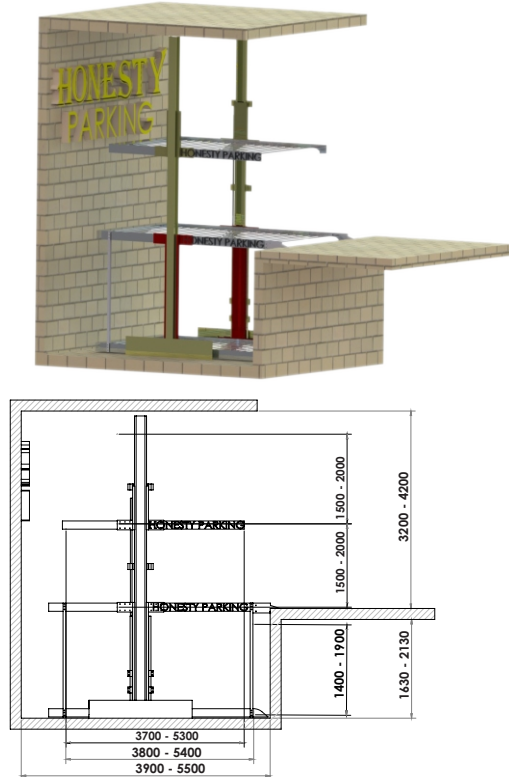

Three interconnected platforms that are driven upwards and downwards together. While one car is parked on each platform. For entry & exit of any car the platform (on which car will be parked)needs to be at the ground level . e.g. - To take out the lower most car, system takes up both the rest platforms together and reaches the lower most car at the ground level.

| Descriptions | Pit Parking (Independent) | |
|------------------------------------|-------------------------------|-----------------------------------|
| | Small Size Car | SUV's |
| Platform Length (mm) | 4800 to 5000 | 4500 to 5000 |
| Platform Width (mm) | 2300 to 2500 | 2300 to 2550 |
| Lifting Capacity per Platform (Kg) | 2000Kg | 2000 |
| Lifting Clearance | 1700 to 1800 | 1800 to 2000 |
| Lifting Operation | Hydraulic & Electromechanical | Hydraulically & Electromechanical |
| Motor on Power Pack | 2.2KW/5HP | 2.2KW/5HP |
| Operating Panel | Automatic / Manual | Automatic / Manual |

Standard Features:

- Installed in basement & open space
- All platforms in pit.
- Easy entry and exit.
- Independent parking system.
- Can fit 3 cars in the system.
- Hydraulic cylinders & chain supported balancing used for lifting mechanism.
- Easy to maintain, low maintenance cost.
- Car height included antenna, rood rails & brackets.
- Modules customized as per site dimensions
- Powder coated, galvanized (optional) or epoxy
- Available in 2 ton & 2.5 ton (optional)

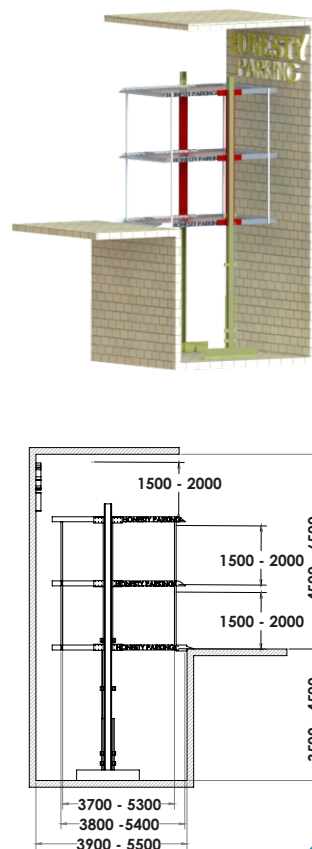

❖ PUZZLE PARKING SYSTEM

Two levels, consisting of top level i.e. Entry level & bottom level i.e. Pit. Entry-level are where the platforms are already at ground level and cars can be easily parked. This level makes horizontal movement using a motor connected to traction. Pit level is the platform in pit & are driven vertically using individual hydraulic system. To drive out any car parked on pit platforms, entry-level platforms shift to their left or right positions making a space clear to bring up the specific pit level platform to ground level. This solution is used where limited height is available and provision for pit is possible.

| Descriptions | Puzzle Parking (Independent) | |
|------------------------------------|-------------------------------|-------------------------------|
| | Small Size Car | SUV's |
| Platform Length (mm) | 4800 to 5000 | 4500 to 5000 |
| Platform Width (mm) | 2300 to 2500 | 2300 to 2550 |
| Lifting Capacity per Platform (Kg) | 2000Kg | 2000 |
| Lifting Clearance | 1700 to 1800 | 1800 to 2000 |
| Lifting Operation | Hydraulic | Hydraulic |
| Sliding with G Motor | Hydraulic & Electromechanical | Hydraulic & Electromechanical |
| Motor on Power Pack | 2.2KW/7.5HP | 2.2KW/7.5HP |
| Operating Panel | Automatic / Manual | Automatic / Manual |
| Sliding G Motor | 0.25HP/0.18KW | 0.25HP/0.18KW |



Standard Features:

- Fast and automatic retrieval of cars from the parking Space without removing any cars parked on the ground level of the system.
- One Slot left empty at each level to make way for the upper platform to pass through.
- Hot dipped Galvanized Corrugated floor plates to reduce dead weight and increase durability.
- Geared motor with minimum Safety factor of 2 with manual brake release.
- Motor- chain operated sliding mechanism.
- Complete system monitored by PLC for smooth and error free automation.
- Back up limit switches provided for each slot for duplex safety.
- Fabricated barriers provided on each platform to provide safety against unwanted lowering.
- Fully automatic integrated operation.
- Emergency shutdown switch.
- Touch screen/numerical keyboard operation panel.

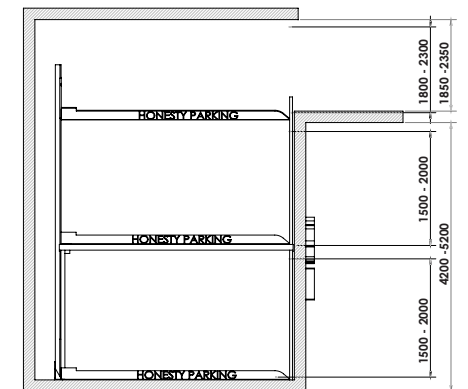

Three levels, 1 consisting of top level i.e. Entry level & 2 consisting of bottom level i.e. Pit. Entry-level are where the platforms are already at ground level and cars can be easily parked. Entry-level platforms are driven horizontally using a motor connected to traction. Upper Pit level platforms are driven vertically & horizontally making space for the lower level platforms to move to ground level, while the lower most level in pit makes only vertical movement.

| Descriptions | Puzzle Parking (Independent) | |
|------------------------------------|-------------------------------|-------------------------------|
| | Small Size Car | SUV's |
| Platform Length (mm) | 4800 to 5000 | 4500 to 5000 |
| Platform Width (mm) | 2300 to 2500 | 2300 to 2550 |
| Lifting Capacity per Platform (Kg) | 2000Kg | 2000 |
| Lifting Clearance | 1700 to 1800 | 1800 to 2000 |
| Lifting Operation | Hydraulic | Hydraulic |
| Sliding with G Motor | Hydraulic & Electromechanical | Hydraulic & Electromechanical |
| Motor on Power Pack | 2.2KW/7.5HP | 2.2KW/7.5HP |
| Operating Panel | Automatic / Manual | Automatic / Manual |
| Sliding G Motor | 0.25HP/0.18KW | 0.25HP/0.18KW |



Standard Features:

- Installed in basement & open space
- Easy entry and exit.
- Independent parking system.
- Can fit minimum 3 cars in the system.
- Chain supported balancing used for lifting mechanism.
- Easy to maintain, low maintenance cost.
- Car height included antenna, rood rails & brackets.
- Modules customized as per site dimensions
- Powder coated, galvanized (optional) or epoxy
- Available in 2 ton & 2.5 ton (optional)

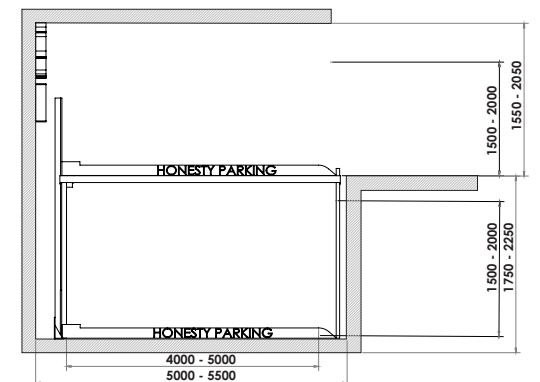

Three levels i.e. entry, middle and lower. Entry-level platforms are driven horizontally using a motor connected to traction. Middle and Lower level platforms are driven vertically using one cylinder connected to both platforms. To drive out any car parked on middle level platforms, entry-level platforms shift to their left or right positions making a space clear to bring down respective middle level platform. Cars parked on entry-level platforms can be directly driven out while to take out lower level cars, connected middle level car shall be retrieved manually.

| Descriptions | Puzzle Parking (Independent) | |
|------------------------------------|-------------------------------|-------------------------------|
| | Small Size Car | SUV's |
| Platform Length (mm) | 4800 to 5000 | 4500 to 5000 |
| Platform Width (mm) | 2300 to 2500 | 2300 to 2550 |
| Lifting Capacity per Platform (Kg) | 2000Kg | 2000 |
| Lifting Clearance | 1700 to 1800 | 1800 to 2000 |
| Lifting Operation | Hydraulic | Hydraulic |
| Sliding with G Motor | Hydraulic & Electromechanical | Hydraulic & Electromechanical |
| Motor on Power Pack | 2.2KW/7.5HP | 2.2KW/7.5HP |
| Operating Panel | Automatic / Manual | Automatic / Manual |
| Sliding G Motor | 0.25HP/0.18KW | 0.25HP/0.18KW |

Standard Features:

- Installed in basement & open space
- Easy entry and exit.
- Independent parking system.
- Can fit minimum 5 cars in the system.
- Chain supported balancing used for lifting mechanism.
- Easy to maintain, low maintenance cost.
- Car height included antenna, rood rails & brackets.
- Modules customized as per site dimensions
- Powder coated, galvanized (optional) or epoxy
- Available in 2 ton & 2.5 ton (optional)

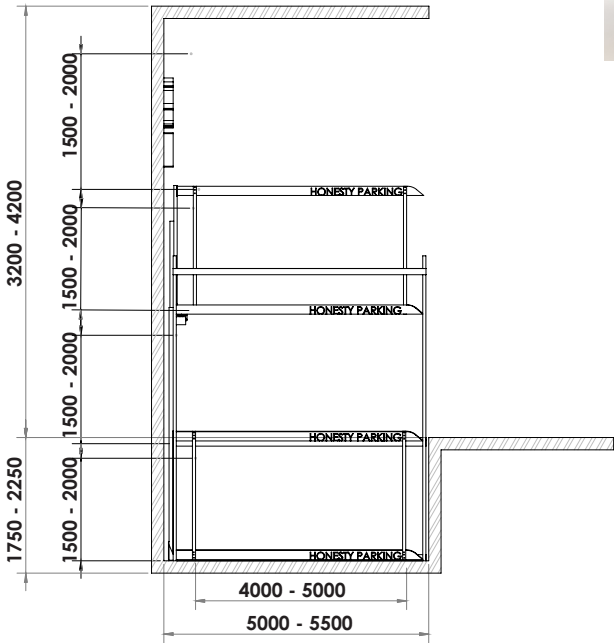

❖ ROTARY PARKING (*)

This System is designed to park cars vertically into the circulation merry go round/crousel either in left or right direction after entering the parking pallet. The operations are automated and one can park without assistance.

| Descriptions | Rotary Parking (Independent) | |
|------------------------------------|---|---|
| | Small Size Car | SUV's |
| Platform Length (mm) | 4800 to 5000 | 4500 to 5000 |
| Platform Width (mm) | 2300 to 2500 | 2300 to 2550 |
| Lifting Capacity per Platform (Kg) | 2000Kg | 2000 |
| Lifting Clearance | 1600 to 1800 | 1800 to 2000 |
| Lifting Operation | Electromechanical, Chain & Rope Mechanism | Electromechanical, Chain & Rope Mechanism |
| Motor on Power Pack | 2.2KW/12HP | 2.2KW/12HP |
| Operating Panel | Automatic with Manual Override | Automatic with Manual Override |

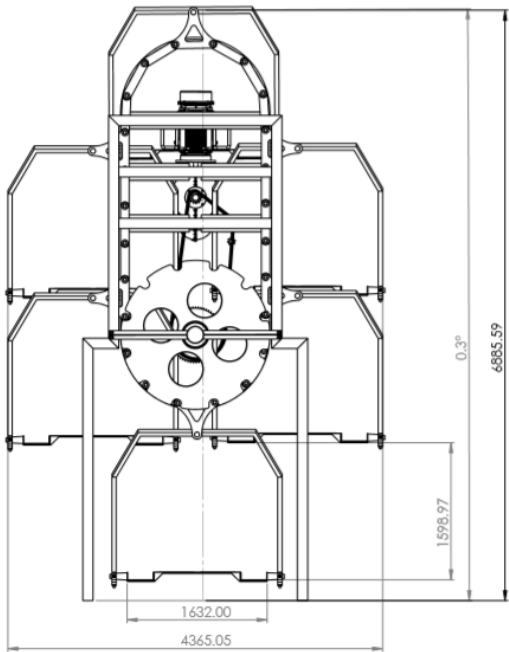

Standard Features:

- Covering smallest area, use the land space efficiently
- Simple operate, automatic computer control management
- Flexible operation, built-in rotary table
- Flexible layout ,less space limited can be attached to a building or an independent type, can also partly underground or type construction, and building a royal reconstruction, landscape can be achieved to one structure.
- Suitable for business use
- *Customized number of platforms. (System size depends on number of platforms)

❖ TOWER PARKING SYSTEM

Having a lift working up and down in the center transporting the vehicles to their designated slots vertically.

| Dmac New Type Tower Parking System Parameter | | | |
|--|--|--------------|--------------|
| | Low Level | Middle Level | High Level |
| Level | 3-6 levels | 7-10 levels | 11-15 levels |
| Device Depth (mm) | 5670 | | |
| Cell Width (mm) | 5400 | | |
| Ground Level Height(mm) | 2200 | | |
| Multi-level Height(mm) | 1700 | | |
| Ground Level Available car (mm) | 5500X2000X2050 | | |
| Multi-level Available Car(mm) | 5000X1850X1550 | | |
| Space rotation height(mm) | 3500 | | |
| Load Capacity(kg) | Ground level 2500, Multi-level 2000 | | |
| Lifting speed (m/min) | 15-30 | | |
| Horizontal speed(m/min) | 12 | | |
| Moto Power(kw) | Horizontal power 1.5kw, lifting power 7.5kw, Rotating power 0.55kw | | |
| Electric Power Source | AC220-420V, 50/60Hz | | |
| Transfer Method | Motor+Gearbox+Chain | | |
| Control Method | PLC | | |
| Operation Method | IC Card and Button | | |

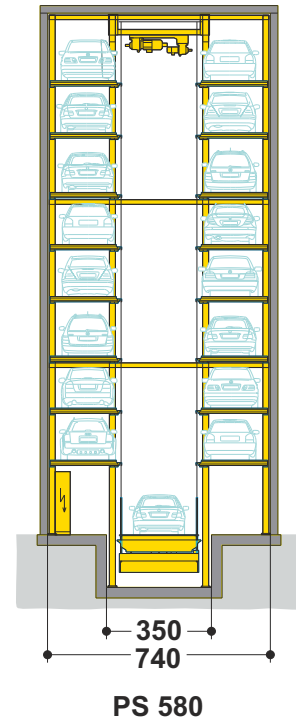

| | | |
|----------------------|--------------------------------|-------------------------------------|
| drive mode | hydraulic / traction | |
| car available | large cars | |
| level of system | 35 levels max | |
| car size(L*W*H) | 5300*1900*1550mm | |
| Car weight | 2350kg | |
| Mode of operation | automatic/manual | |
| Speed of operation | Lift | hydraulic:60m/min traction:120m/min |
| | Slide | 7.5m/min |
| | Turning | 4rpm |
| Motor \power | Lift | 30kw |
| | Slide | 0.2kw |
| | Turning | 1.5kw |
| Power of electricity | For Motor | 380V/50HZ 2phase 5wires |
| | For control | 220V/50HZ 2phase 5wires |
| Number of cars | based on customer requirements | |

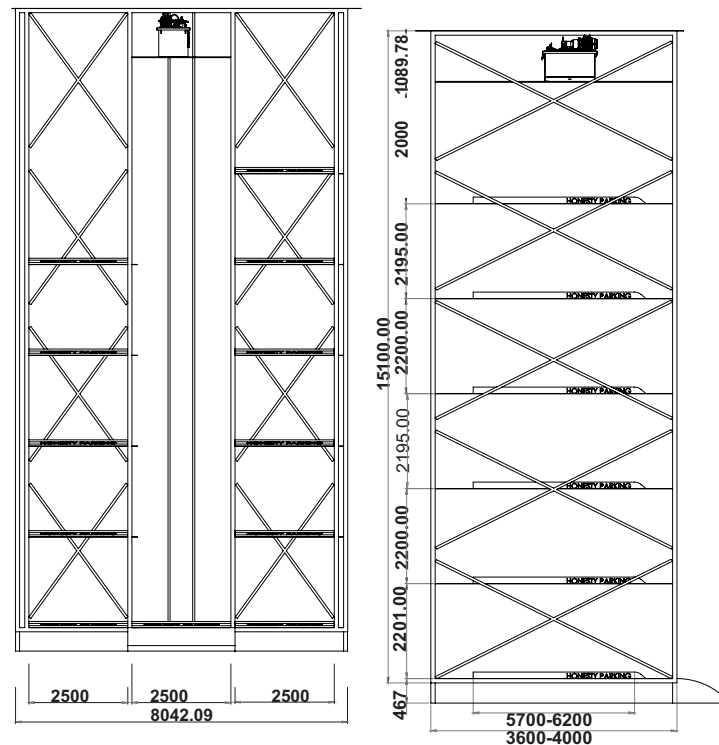

Standard Features:

- High speed Geared motors with counter weight and Guides for smooth lift and lowering.
- Turntable on the ground level for getting the car in the Drive out position
- Motor- Chain operated Sliding Mechanism.
- Complete system monitored by PLC for smooth and error free automation.
- Back up Limit switches provided for each slot for duplex safety.
- Robust Steel structure.
- Fully automatic integrated operation.
- Emergency Shut Down switch.
- Optional Touch Screen/Numerical Keyboard / RFID Swipe card operation Panel.

OUR INFRA STRUCTURE

Manufacturing Facility



CNC Sheet Bending Machine



CNC Sheet Cutting Machine



CNC Laser Machine



Plasma Cutting Machine



Miling Machine



High Accuracy Lethe Machine

Research & Development Team

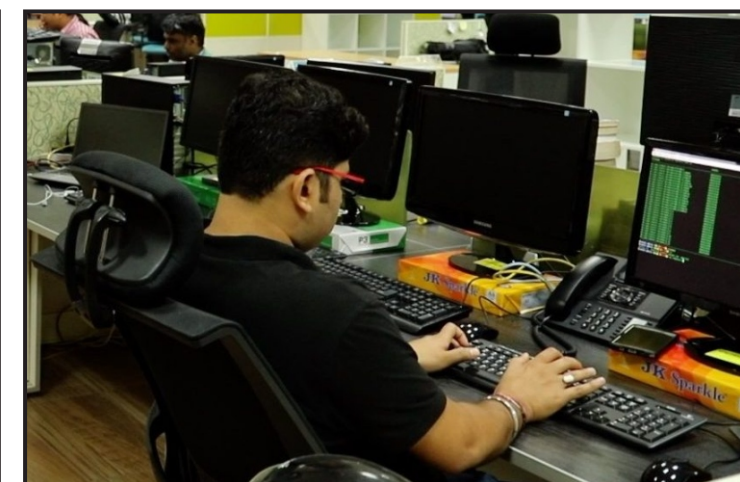

R&D Center

India

Sales & Service Network



Our Sales & Team

Hydrabad | Bangalore | Chennai | Kochi | Jaipur | Dehradun | Chandigarh | Ahemdabad | Indore |
Mumbai | Pune | Kolkata | Guwahati

HONESTYTM
PARKING
HONESTY AUTOMATION PVT. LTD.
A Unit of Honesty Group

(Dealer)

HONESTY AUTOMATION PVT. LTD.

Registered Office :

WZ39-A, 3th Floor, Street No. 6 Ramgarh Colony,
Basai Darapur Near Ratan Park, New Delhi-110015

Corporate Office :

D-4, Ground Floor, Kailash Park, New Delhi-110015

Manufacturing Unit Office :

Plot No-373 A, Murlipur Goyla, Behind Tata Motors Ltd.
Deva Road Industrial Area Chinhat, Lucknow, Uttar Pradesh - 226028
www.automatic-carparking.com | www.honestygroup.co.in



Mob. : +91 9999623650
E-mail : sales1@honestygroup.co.in

- Please refer Technical Data Sheet on our website for dimensions and other details.
- Photographs are for reference only and actual product may vary.
- Specifications are subject to change without notice.
- We reserve the right to incorporate changes, modify and upgrade as found appropriate for specific application of parking.
- For your special requirements if any, pl do contact your nearest local representative.
- Contact details of our regional representatives can be found on our website. In case of no representation in your region, please contact the factory directly

